

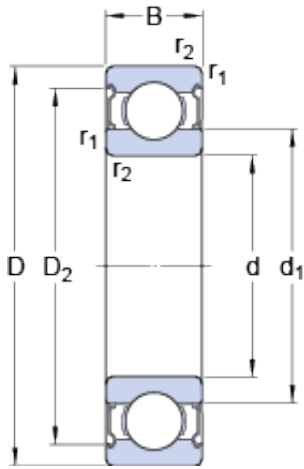

Precision Parts Bearing Co., Ltd.



6215-2Z Bearing 2D drawings and 3D CAD models

SKF 6215-2Z double dust cover bearings

Bearing No. 6215-2Z

Size	130x75x25 mm
Bore Diameter	130 mm
Outer Diameter	75 mm
Width	25 mm
d	75 mm
D	130 mm
B	25 mm
d ₁	92.05 mm
D ₂	116.5 mm
r _{1,2} - min.	1.5 mm
d _a - min.	84 mm
d _a - max.	92 mm
D _a - max.	121 mm
r _a - max.	1.5 mm
Basic dynamic load rating - C	68.9 kN
Basic static load rating - C ₀	49 kN
Fatigue load limit - P _u	2 kN
Reference speed	10000 r/min
Limiting speed	5300 r/min
Calculation factor - k _r	0.025
Calculation factor - f ₀	14.7
Category	Single Row Ball Bearings
Inventory	0.0
Manufacturer Name	SKF
Minimum Buy Quantity	N/A



Precision Parts Bearing Co., Ltd.

Weight / Kilogram	1.26
EAN	7316570902532
Product Group	B00308
Enclosure	2 Metal Shields
Precision Class	ABEC 1 ISO P0
Maximum Capacity / Filling Slot	No
Rolling Element	Ball Bearing
Snap Ring	No
Internal Special Features	No
Cage Material	Steel
Internal Clearance	C0-Medium
Inch - Metric	Metric
Long Description	75MM Bore; 130MM Outside Diameter; 25MM Outer Race Diameter; 2 Metal Shields; Ball Bearing; ABEC 1 ISO P0; No Filling Slot; No Snap Ring; No Internal Special Features
Category	Single Row Ball Bearing
UNSPSC	31171504
Harmonized Tariff Code	8482.10.50.68
Noun	Bearing
Keyword String	Ball
Manufacturer URL	http://www.skf.com
Manufacturer Item Number	6215-2Z
Weight / LBS	2.77
Bore	2.953 Inch 75 Millimeter
Outside Diameter	5.118 Inch 130 Millimeter
Outer Race Width	0.984 Inch 25 Millimeter
d ₁	92.05 mm
D ₂	116.5 mm
r _{1,2} min.	1.5 mm



Precision Parts Bearing Co., Ltd.

d_a min.	84 mm
d_a max.	92 mm
D_a max.	121 mm
r_a max.	1.5 mm
Basic dynamic load rating C	68.9 kN
Basic static load rating C_0	49 kN
Fatigue load limit P_u	2.04 kN
Calculation factor k_r	0.025
Calculation factor f_0	14.7
Mass bearing	1.23 kg